



ZigBee Switch

Distinguishing Feature

Support access to Samsung SmartThings Hub, Philips HueHub, IKEA Hub from IKEA or ZigbeeHA from other companies hub

Can be connected to electric lights, sockets, fans, motors refrigerators, washing machines clothes washer water heater and other electrical appliances.

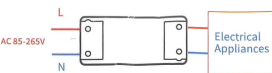

Wire correctly according to the instructions of the enclosure. This switch must zero live wire power supply. Live installation is strictly prohibited!

Note: The switching principle of this equipment is through the control circuit fire wire So as to realize the electrical work and stop. This device must the device can work normally only if the power supply is zero live wire.

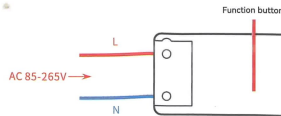

1. Appliance wiring instruction.

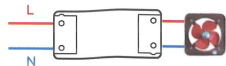

2. Ceiling lamp wiring instruction.

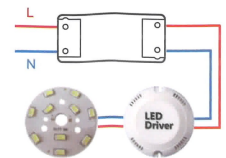

3. One wire wiring instruction.

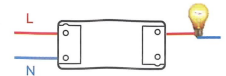

Notte: The switch must be powered up by N and L wires.

Configuration Steps



Works with Amazon Alexa



- 1 Confirm that the indicator light of the ZigBee switch is blinking, If the indicator light is always on, press and hold the function key until the indicator The light is flashing or the ZigBee switch is powered off, Then power on for 3-8s, repeat five times, then re-enter the configurationSet state.
- 2 Ask: "Alexa, discover my devices".

- 3 Wait for the indicator light of the ZigBee switch to be on. At this time, the device Connected to echo plus or second-generation echo show.
- 4 Ask, "Alexa, turn off first light." This will turn the Controller off.
- 5 You can use the Amazon Alexa APP to add group, routines or modify device names such as bedroom light or office switch, At this point you can use the Alexa APP or Voice to control the devices.



Works with Sansung SmartThings hub & Amazon Alexa



- 1 Confirm that the indicator light of the ZigBee switch is blinking, If the indicator light is always on, press and hold the function key until the indicator The light is flashing or the ZigBee switch is powered off, Then power on for 3-8s, repeat five times, then re-enter the configurationSet state.

- 2 Open the SmartThings APP and add the Controller. When the red indicator is always on, the Controller has been added to the SmartThings hub. If the APP does not recognize the device type, please refer to the SmartThings Config. pdf document.
- 3 Enable SmartThings Skill in the Alexa APP or alexa.amazon.com
- 4 Ask: "Alexa, discover my devices." can add Controller to Amazon Smart Home.
- 5 You can use SmartThings APP or Alexa APP to add group, routines or modify device names such as bedroom light or office switch.
- 6 At this point you can use the Alexa APP or Voice to control the devices.

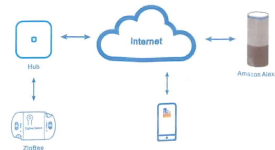

SmartThings APP and Alexa APP Operation (Add device, group, routines)

Alexa APP

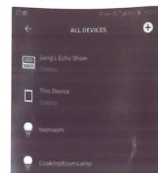

1. In the Alexa APP interface click '+' icon, You can add devices and groups. In The device list interface you can control or modify the device type and name, as shown in the following picture

2. In the Alexa APP Smart Home interface you can operate the devices conveniently

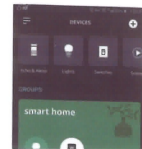

3. In the Alexa APP Routines interface you can set up some devices and events (Ask, "Alexa, good morning." It will turn on the bedroom lights, open the curtains, and forecast the weather, traffic conditions, to-do items, etc.)

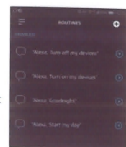

SmartThings APP



1. Click "+" to add or reset the device at the upper right corner on the all device list screen in the Smart Things APP.

2. Select "Add Device" in the pop-out window

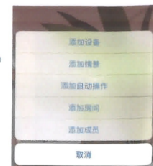

3. Select 'eWeLink' icon to add device on the add device screen

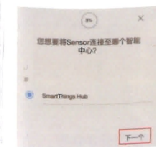

4. Click "Next" on the default hub connection interface

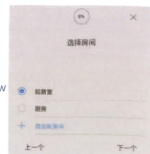

5. Choose the room you want after entering this interface, or click "add new room", then click "Next"



6. Do what app tells you and wait patiently



7. After the device is successfully connected, name the device and click "Done"

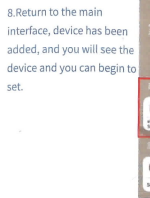

8. Return to the main interface, device has been added, and you will see the device and you can begin to set.

